

POND DATA

1. AREA AT NORMAL WATER LEVEL = 7.84 ACRES.
2. 20 FOOT MAINTENANCE BERM PROVIDED AROUND THE PERIMETER OF THE POND.
3. INLET AND OUTLET SEPARATION CALCULATIONS
 - 3.1. MAXIMUM FLOW PATH FROM INLET TO SOUTHERN OUTFALL IS APPROXIMATELY 1,380 FEET.
 - 3.2. FLOW LENGTH FROM INLET TO HIGH FLOW OUTFALL IS APPROXIMATELY 1120 FEET.
 - 3.3. FLOWPATH RATIO (FPR) = 1120/1380 = 0.81. 0.81>0.80; THEREFORE THE INLET AND HIGH FLOW OUTFALL MEET SEPARATION GUIDELINES.
4. TOTAL VOLUME BELOW NWL = 92.3 AC-FT

POND COORDINATE TABLE

No.	Northing	Easting	Desc.	No.	Northing	Easting	Desc.
1	1,240,253.05	434,387.33	PT	25	1,239,180.69	433,943.46	PRC
2	1,240,390.54	434,387.33	PC	26	1,239,206.30	433,953.84	PRC
3	1,240,439.11	434,358.15	PT	27	1,239,221.01	433,958.78	PT
4	1,240,464.10	434,311.14	PC	28	1,239,388.14	433,960.16	PC
5	1,240,475.81	434,264.20	PT	29	1,239,414.40	433,945.10	PRC
6	1,240,475.81	434,223.75	PC	30	1,239,423.46	433,939.40	PT
7	1,240,456.19	434,164.27	PT	31	1,239,466.72	433,939.40	PC
8	1,240,448.54	434,153.92	PT	32	1,239,476.06	433,945.61	PT
9	1,240,428.84	434,137.39	PT	33	1,239,475.44	433,944.51	PC
10	1,240,318.44	433,988.20	PT	34	1,239,501.98	433,960.93	PT
11	1,240,308.40	433,964.53	PT	35	1,239,581.05	433,961.58	PC
12	1,240,296.50	433,948.45	PC	36	1,239,595.93	433,976.61	PT
13	1,240,216.11	433,907.94	PT	37	1,239,595.61	434,171.58	PC
14	1,240,058.15	433,907.94	PC	38	1,239,635.61	434,211.64	PT
15	1,240,008.15	433,921.33	PT	39	1,239,675.95	434,211.64	PC
16	1,239,936.79	433,962.54	PC	40	1,239,695.13	434,207.82	PRC
17	1,239,817.08	433,962.70	PT	41	1,239,757.42	434,295.06	PRC
18	1,239,543.31	433,805.65	PC	42	1,239,746.12	434,324.80	PT
19	1,239,455.80	433,799.79	PT	43	1,239,746.04	434,373.25	PC
20	1,239,375.09	433,832.69	PC	44	1,239,790.67	434,418.33	PT
21	1,239,329.79	433,841.57	PT	45	1,240,175.85	434,421.50	PC
22	1,239,193.97	433,841.57	PC	46	1,240,212.33	434,408.07	PT
23	1,239,158.97	433,876.57	PT	47	1,240,223.58	434,398.32	PC
24	1,239,158.97	433,918.67	PC	---	---	---	---

Elevations based on City of St. Petersburg Vertical Datum (COSP)
 NGVD 29 = COSP - 97.00'
 NAVD 88 = COSP - 97.88'

ERD ENVIRONMENTAL RESEARCH & DESIGN, INC.
 ENGINEERING • SCIENCE • CHEMISTRY • RESEARCH
 3419 TRENTWOOD BLVD., SUITE 102, ORLANDO, FL 32812
 TELEPHONE: 407-855-9465 • FAX: 407-826-0419
 ENGINEERING BUSINESS No. 6244

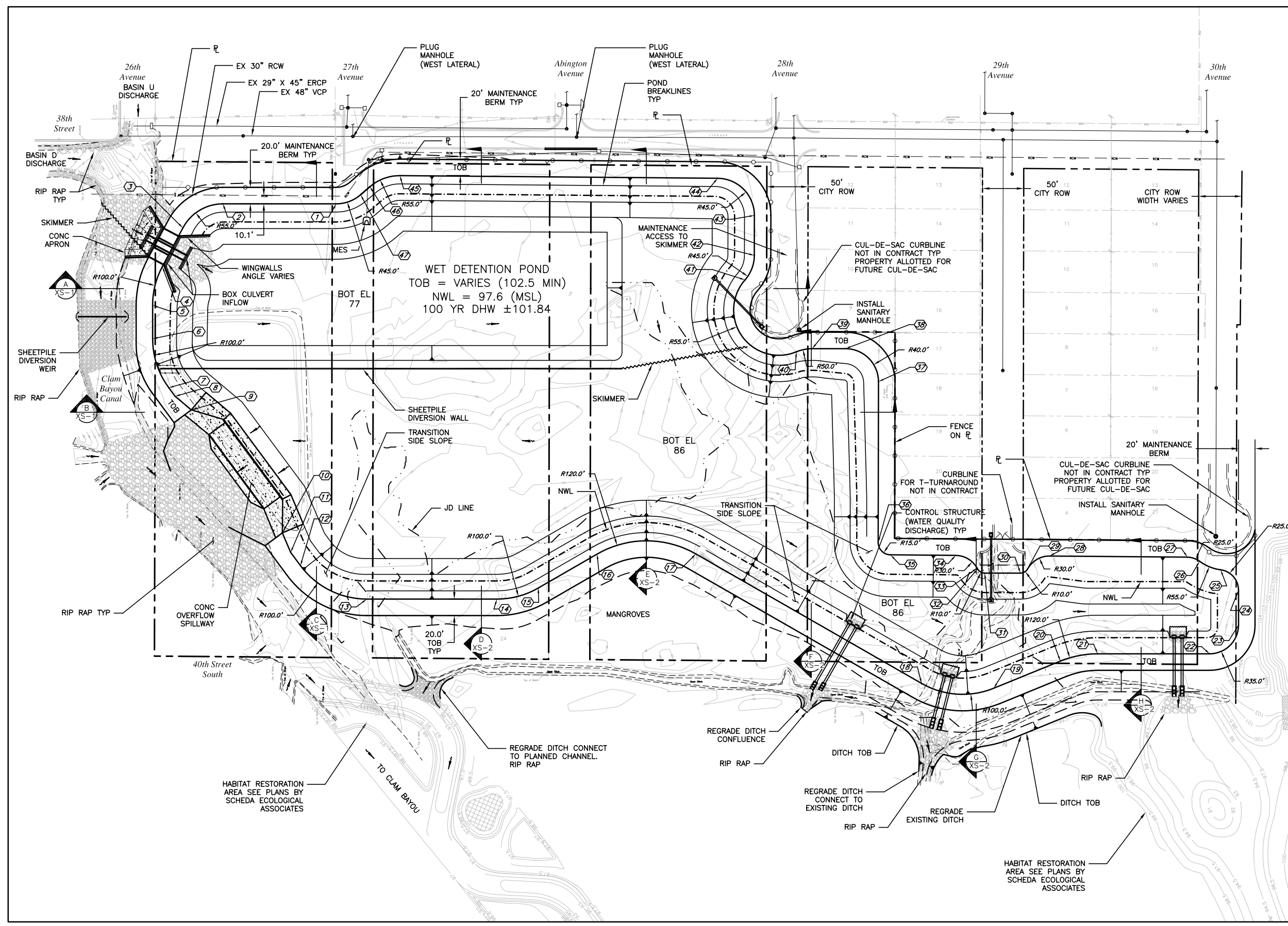

RECORD DRAWINGS

SURVEYED BY	DRAWN BY
APPROVED BY	DATE
SUPERVISING ENGINEER	DATE



SOUTHWEST FLORIDA WATER MANAGEMENT DISTRICT
 2379 Broad Street
 Brooksville, FL 34604
 (352)796-7211

CLAM BAYOU STORMWATER TREATMENT PROJECT CENTRAL POND DESIGN
MASTER SITE PLAN

F	100% CONSTRUCTION PLANS	JAM	10/09
E	FDEP WASTEWATER PERMIT	JAM	7/09
D	90% CONSTRUCTION PLANS	JAM	6/09
C	60% CONSTRUCTION PLANS	JAM	3/09
B	PRELIMINARY REVIEW MEETING	JAM	2/09
REV	REVISION	BY	DATE



Professional Civil Engineering Services
 12315 Wycliff Pl
 Tampa, FL 33626
 PHONE: (813) 404-8872
 www.5mcivil.com
 FBPR Certificate of Authorization No: 26,929

JOB NO.	081017	DWG NAME	C-1.DWG
DESIGNED BY	JAM	SCALE	VERT. N/A
DRAWN BY	JAM	HORIZ.	AS NOTED
CHECKED BY	JAM	SHEET NO.	C-1
DATE DRAWN	12/11/08	ENGINEER OF RECORD:	JESUS A. MERLY, PE FL Reg No. 58113